

EQUIPMENT REQUIRED:

Power Drill & Bits

**Sabre Saw or Kett Panel Saw
metal-cutting blades**

Level

Hacksaw or chop saw

Drywall adhesive & Caulk Gun

Mounting Hardware:

including flat-head fasteners

All installations require FOUR accurate measurements. Verify sizes and quantity of units delivered prior to installation. Contact Educational Equipment with any discrepancies at 330-673-4881.

Hanging hardware is NOT included with each unit. It is the responsibility of the installer to furnish the required fasteners for each wall type.

1. Lay out all pieces on floor & match up pieces into configuration. Re-check your order's installation measurements & trim sizes for each location to ensure clean baseboard and ceiling locations.

2. Set **TRIM#1** at bottom location. Install using mounting hardware (Accordingly to your wall construction) through the holes provided at desired elevation using chalk line & level. **NOTE:** Flat-head fasteners must be flush to allow panels to pass over.

3. Repeat installation for **TRIM#2** using level. Set **TRIM#4** (L-ANGLE) into place & mark the wall for **TRIM#3** placement. Set aside **TRIM#4** & install **TRIM#3**.

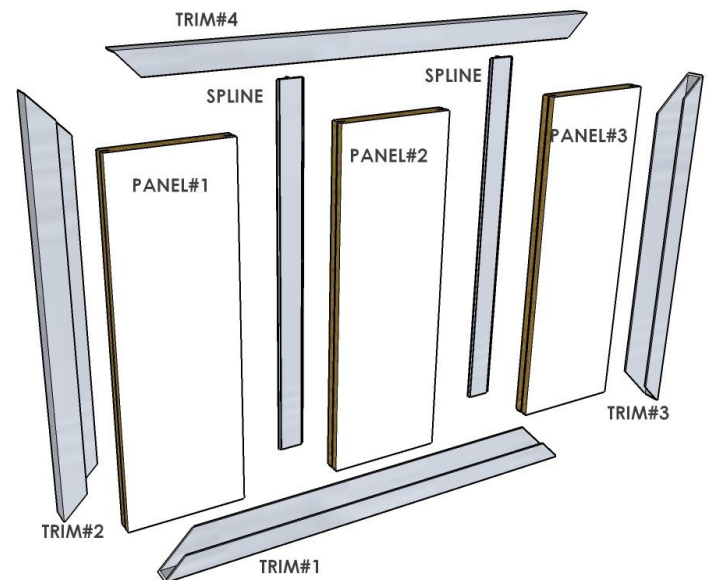

4. Apply commercial grade glue to the back of **PANEL#1** with caulking gun. Set **PANEL#1** into bottom **TRIM#1**. Slide panel fully into upright **TRIM#3**.
5. Slide **SPLINE** into position.

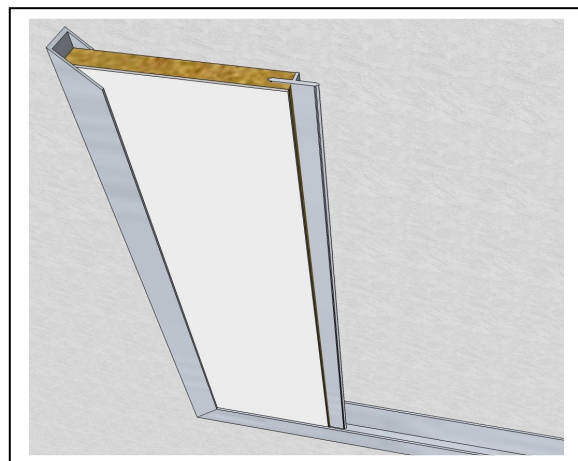

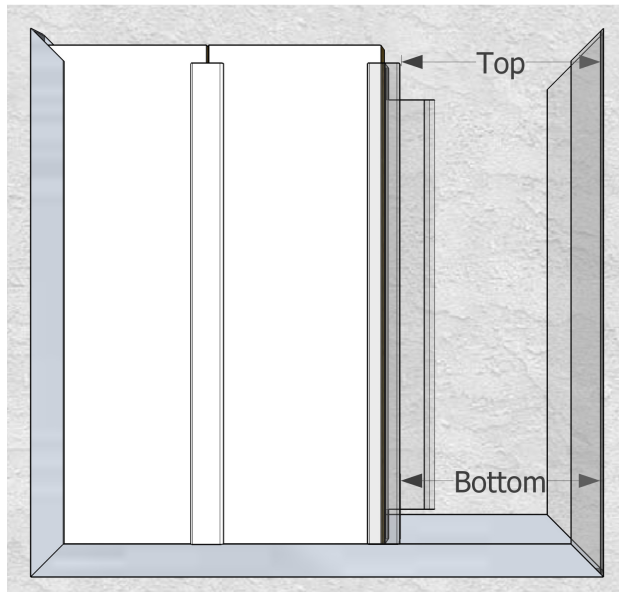

6. Repeat Steps 4-5 for all panels & mullion excluding the final panel. Measure from Mullion edge to the inside TRIM at BOTH Top & Bottom as shown above.

7. The final panel will need to be ripped down. Cut according to TOP & BOTTOM measurements MINUS 1/8" with a reciprocating saw & metal blade. Test that the panel fits before gluing.

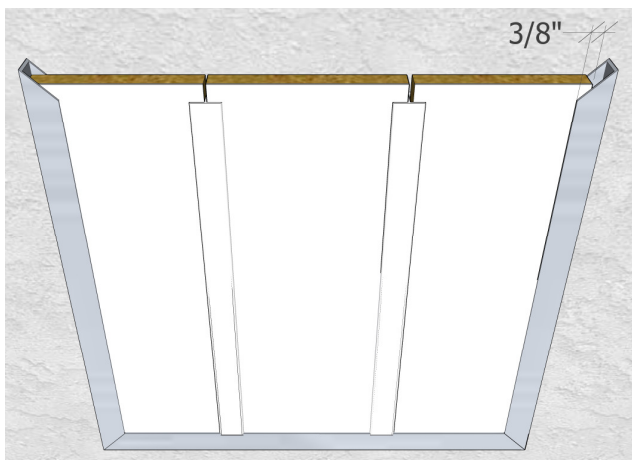

8. Slide last Panel into TRIM first, then drop into bottom trim. Slide the panel over to 3/8" inside TRIM face shown above.

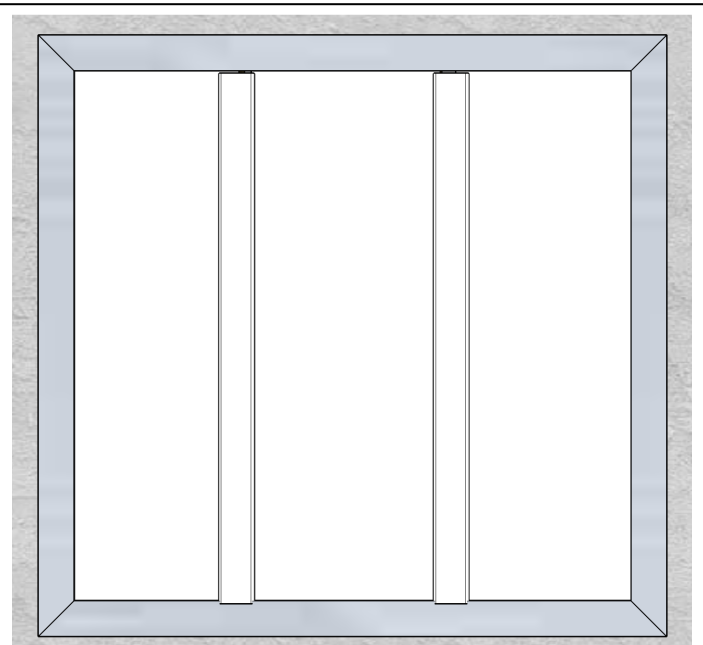

9. Glue the inside of **TRIM#4** & set into place. Place masking tape at the corners to ensure tight miters until the glue sets.